

# INSTALLATION MANUAL

## DM-WFC2 / 3 WFL1 - WIFI REMOTE CONTROLS



Page: 1

# WiFi remotes

DM-WFC2 DM-WFC3 DM-WFL1



## Installation manual

How to install the DM Series wifi remote control



## What have you bought

These wifi remotes are devices that can add the remote control via the internet via WiFi to any electrical device. You can connect these remote controls to your WiFi network and then operate them as you wish with the included app, either in local WiFi connection or through the Internet, when you are not at home.

This manual tells you how to install and configure the devices.

# Electrical connection

## DM-WFC2

DM-WFC2 is a switch with stable ON / OFF switching, remotely controllable via wifi. You can use it to power any 220V electrical equipment up to 10A, such as lighting, sounders, irrigation, etc. It also has a switch input to operate in parallel with a traditional local control. In this way you can operate the device indifferently through the app with the wifi or with the local switch.

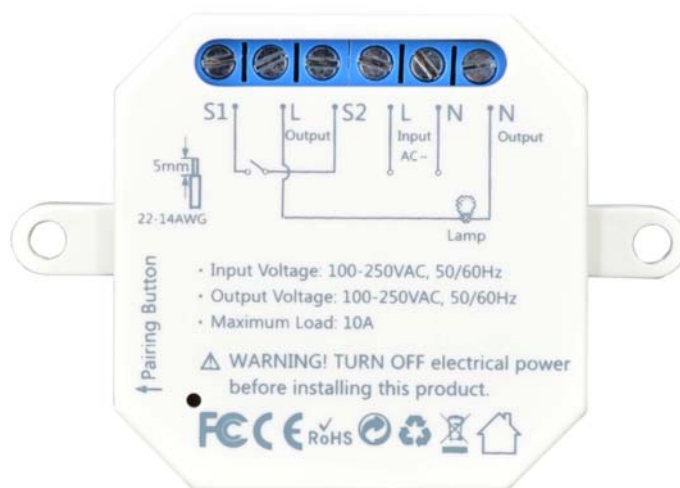

### CONNECTION WITHOUT LOCAL SWITCH LN = Connect the

110-250V AC power supply

Loutput-Noutput = Connect the AC power supply of the device to be controlled

### CONNECTION WITH LOCAL SWITCH LN = Connect the

110-250V AC power supply

Loutput-Noutput = Connect the AC power supply of the device to be controlled. This output provides the output power voltage.

S1-S2 = Connect the local switch

Here you see the connection diagram of a lighting also controlled locally from two points with 2 diverters.

# INSTALLATION MANUAL

## DM-WFC2 / 3 WFL1 - WIFI REMOTE CONTROLS



Page: 4

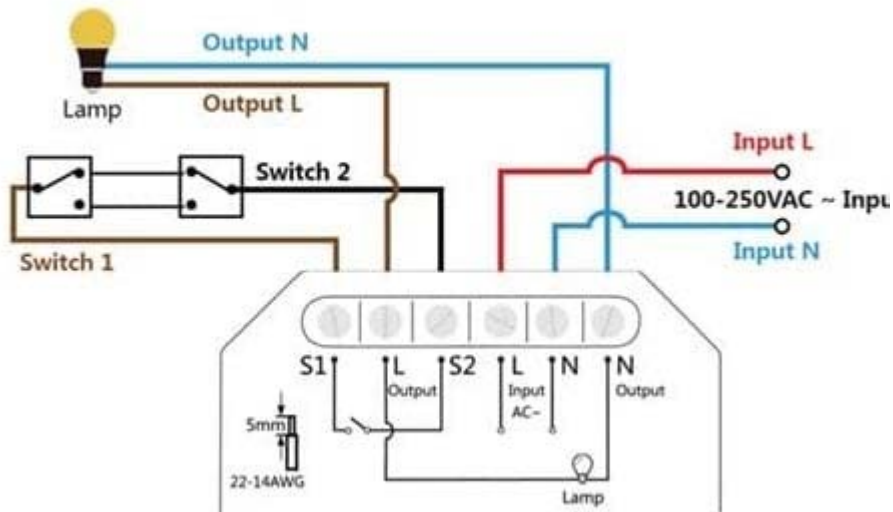

You can install the module in a junction box or directly in the 503 switch box as in this example. If you are using a very small cassette you can remove the side flaps with the fixing holes using pliers.



### USE OF LOCAL COMMAND

You will learn how to use the wifi command shortly in the app explanations. As regards the local switch, remember that each time the switch is operated, both in opening and closing, the status of the ON / OFF relay will change. So the switch on-off position will not always be the same. This is normal, because you have to consider that the user can turn on the device with the wifi app and then turn it off with the local switch, and vice versa.

# Electrical connection

## DM-WFC3

DM-WFC3 is a remote control for electric locks, gate openers or garage doors. It provides an impulse contact that operates the device and also a status contact that you can optionally connect to signal to the remote control whether the door is open or closed. You can use this remote control for all devices that require an impulse command instead of an ON / OFF switch.



LN = Connect the 110-250V AC power supply

S1-S2 = Connects the electric lock or gate opener command (NO contact closes for 2 seconds at each command)

S3-S4 = Connect a contact that closes when the door is closed

Terminals S1-S2 provide a 3 second pulse whenever a remote command is executed. If you have other local buttons to control the door or gate, you can connect them in parallel on the same control terminals. If your drive (electric lock, garage door, etc.) has a contact that closes when the door is closed, you can connect this contact to inputs S3-S4, so our app can tell you with certainty whether the door is open or closed.

Here is a practical connection diagram

# INSTALLATION MANUAL

## DM-WFC2 / 3 WFL1 - WIFI REMOTE CONTROLS



Page: 6

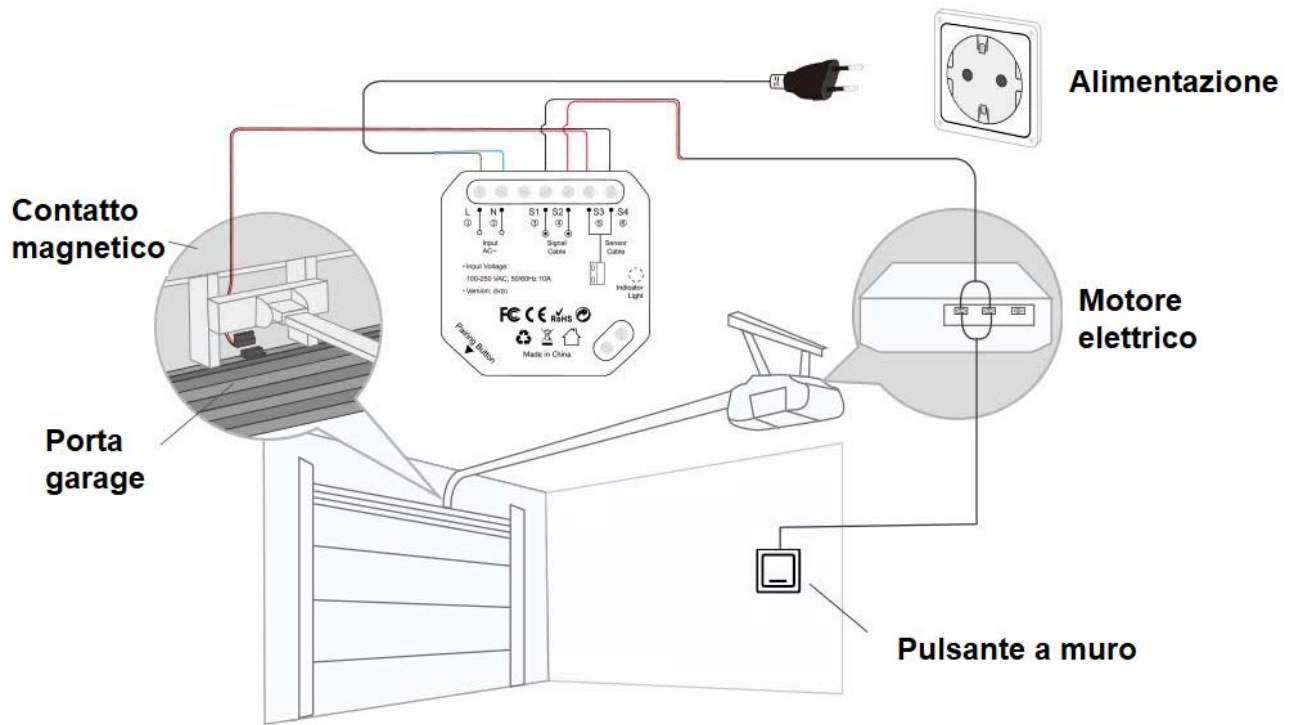

The two terminals separated from the main terminal block are not used.

# Electrical connection

## DM-WFL1

DM-WFL1 is a WiFi remote-controlled E27 lamp holder. You can simply screw it between the original socket and the bulb. It is ideal for outdoor lighting on poles.





# Positioning

When choosing the installation position of the product, pay attention to these precautions

## **CHECK THE WIFI COVERAGE**

Before placing the remote control in its final location, remember that this device must connect to your wifi network in order to function. You should therefore check with your mobile phone that the point where you want to put it there is good coverage of your wifi network. If you see that the signal is very poor, you should intervene on your wifi network, perhaps enhancing it with a repeater.

Do not install the product in an area with poor wifi signal as it would then be unreliable in its operation.

## **NO METALLIC CONTAINERS**

Be careful not to close the remote control card in a metal container as this would shield the wifi signal. On the other hand, you can easily close the plastic cover of the junction box because it does not provide an important shield.



## Download the Smart Life app

In order to use the product with your mobile you must first connect the device to your wifi network. To do this you need the APP **Smart Life** which you can download for free from Google Play or Apple Store. It is a very popular app in home automation.



WiFi connection

At the first start you have to create an account by entering a valid email address. Press **CREATE A NEW ACCOUNT** and then wait for the code via email to confirm your subscription.

If you don't have an email address you can also use your phone number by pressing **Use Phone Number** and get the verification code via text message

Once you have created your account, you have your own space in the cloud where you can also upload many WiFi remotes to control different devices.

# Configure the remote control

In order to use the remote control with your mobile you must first connect the device to your wifi network. It is a very easy operation to perform, thanks to the APP you just downloaded.

Note that on the electronic board there are: **1 button**

**called PAIRING**

**1 red LED that can be seen transparently through the plastic** Locate them because you will need them in these operations

1 - Press ADD DEVICE

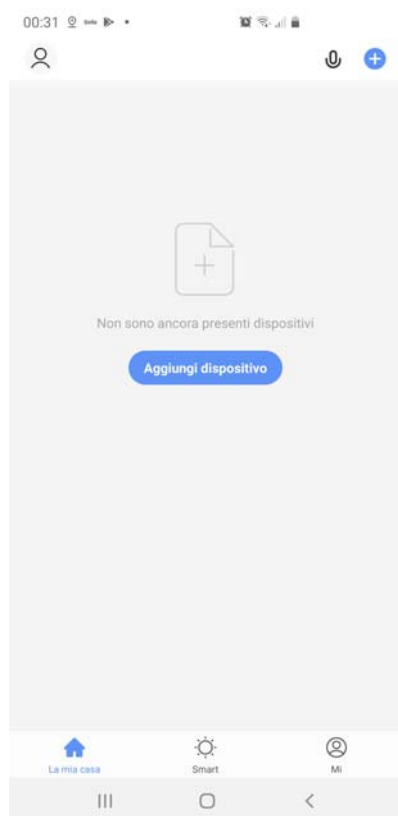

2 - Choose the type of device according to the following table DM-WFC2 = SWITCH (WIFI) - Do not use the Zigbee version DM-WFC3 = DOOR OPENER or SMART GARAGE DOOR OPENER DM-WFL1 = SWITCH (WIFI) - Do not use the Zigbee version



3 - Now power up your device and check the red led that can be seen in transparency through the external plastic, on a new piece it should be flashing. If it does not flash, press the PAIRING button on the device for 5 seconds, until the red LED starts flashing. When the LED flashes press the blue app button to confirm



4 - Now you have to choose your wifi network to connect to and enter the access password. If you have networks with different frequencies remember that the device only supports WiFi networks at 2.6 GHz. Press CONFIRM to start connecting the device to your wifi network.

The connection takes about 30 seconds during which the app connects the remote control to your wifi network and registers it in your account on the cloud to be able to access via the Internet.

# INSTALLATION MANUAL

## DM-WFC2 / 3 WFL1 - WIFI REMOTE CONTROLS



Page: 13

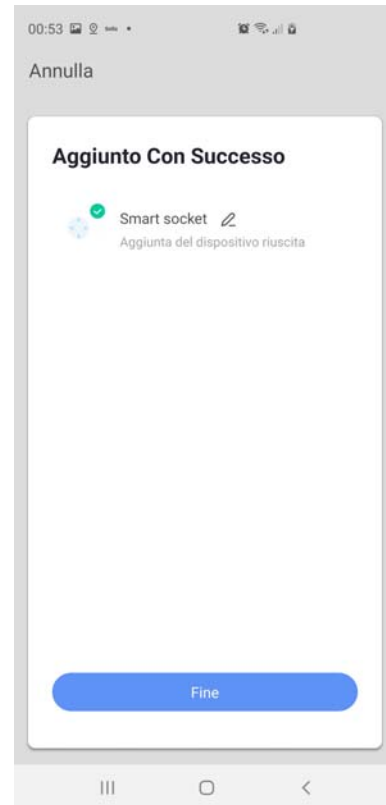
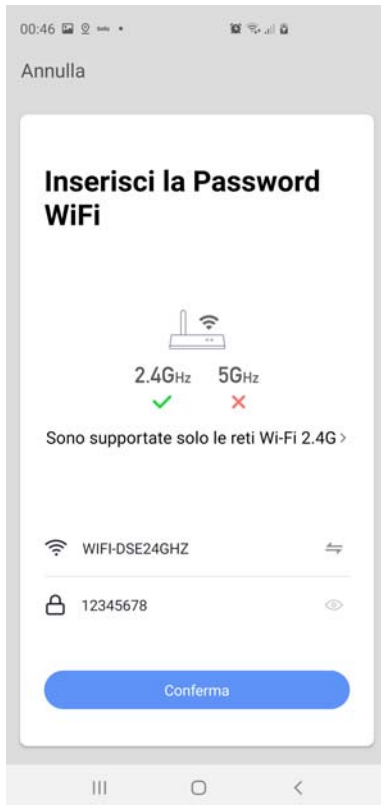

## Use the remote

Now that you have set up your device you can control it with the app. Thanks to the P2P cloud server you can also control it over the Internet. The icons and options you see in this section may vary slightly depending on the type of remote you have purchased.

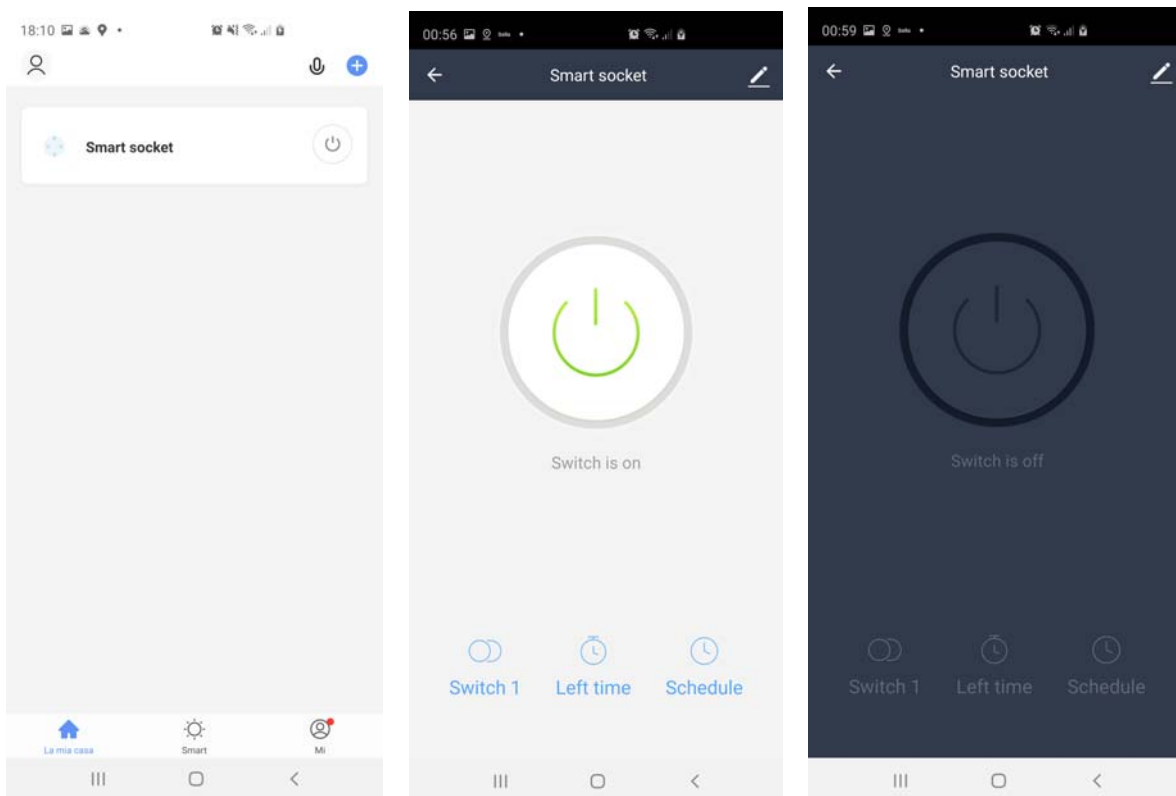

**ON / OFF**-The remote control is controlled simply with a button. The button icon varies depending on the status of the remote so you can tell if the command is on or off.

**LEFT TIME or COUNTDOWN**-Here you can set a timer so that the remote control changes state (for example if it is active, it turns off) after a certain time. You can set the timer for a few seconds, but also up to 24 hours.

**SCHEDULE**-Here you can program automatic switching (ON or OFF) at a certain time on different days of the week. You can enter several automatic schedules that repeat only once, or every day of the week, for example every Monday. With this programmer you can create real programmed automations. You can also set up a notification that alerts you to the execution of the scheduled task.

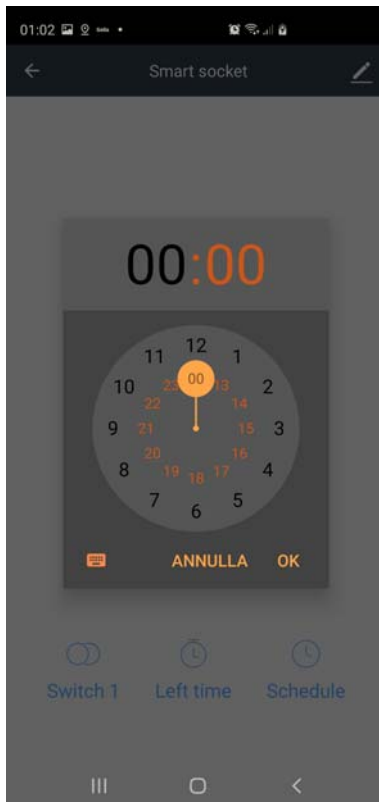

**RECORD**-Here you can see the history of your activations

**ALARM**-Some remotes that have a status detection allow you to receive notifications on the phone if the status is open or closed.

# Advanced options

From the device command page you can access some advanced options by pressing the edit icon (pencil) at the top right

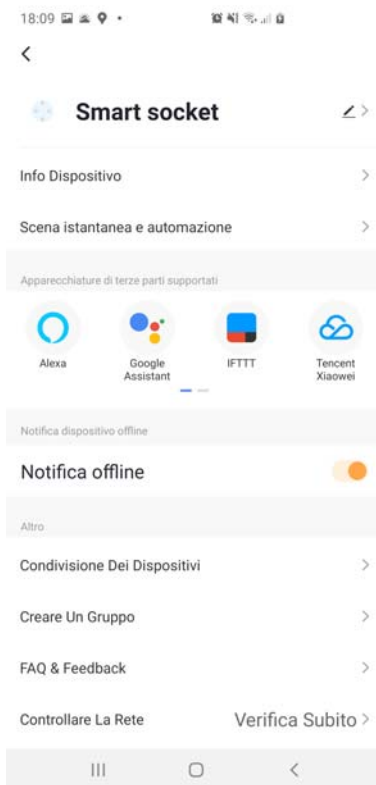

## VOICE COMMAND

You can connect your remote control with other voice control devices.

The remote is compatible with the most common voice control devices such as Amazon Echo (ALEXA) and Google Assistant. So you can also control the relay by giving voice commands.



## OFFLINE NOTIFICATION

You can enable this feature to be notified when your device is unreachable for 30 minutes due, for example, to a problem with your Internet line or due to a power failure.